

A3-USA, Inc Packaged Membrane Bioreactors

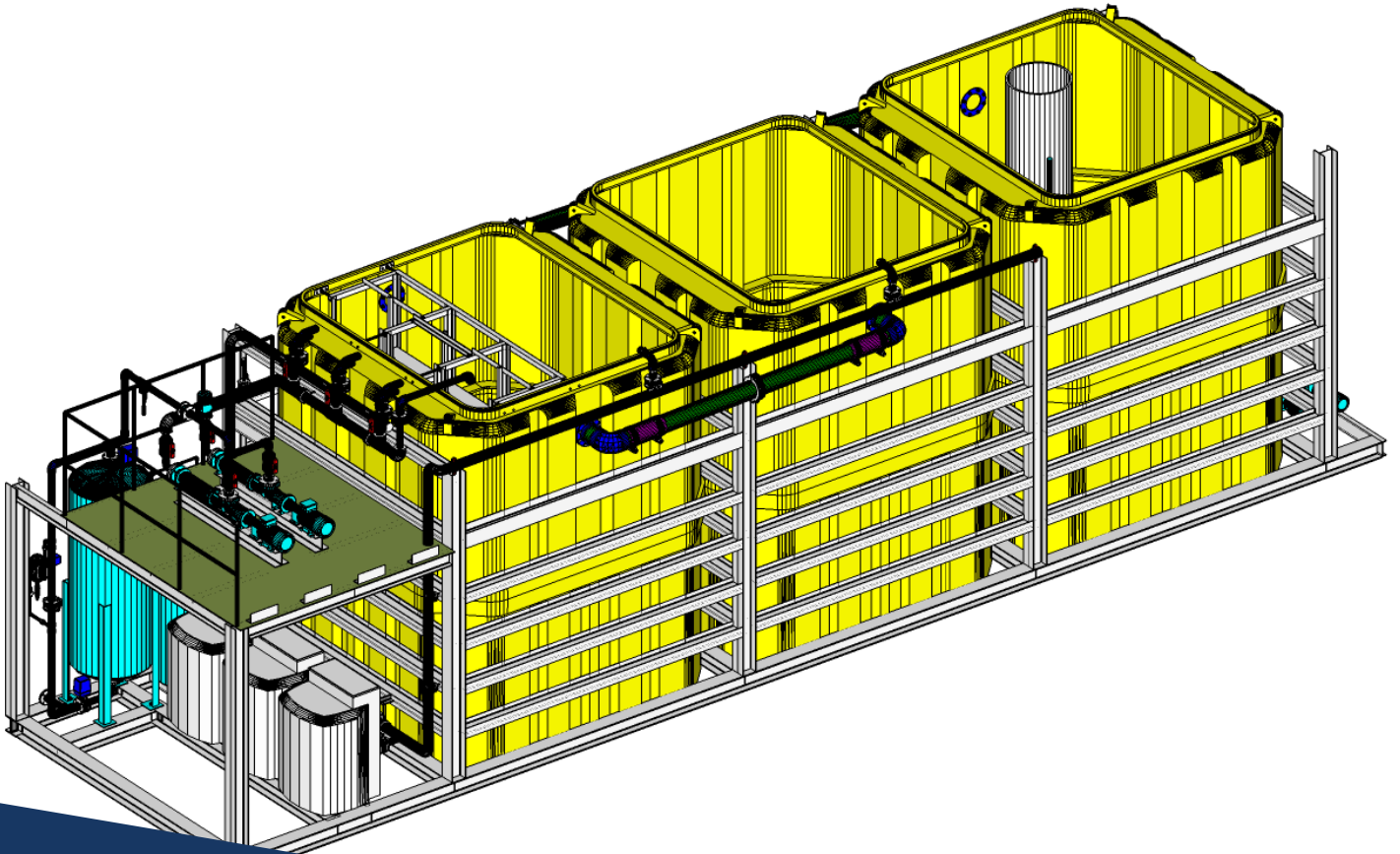

Modular MBR

Applications

- Decentralized Municipal
- New Developments
- Rural Communities
- Brewery
- Soft Drink
- Food Production
- Mancamps
- Agriculture
- Textile
- Military
- Resort/Casino
- Hospitals

HDPE PROCESS TANKAGE: AN-OXIC, AEROBIC, MEMBRANE AS NEEDED

Versatile HDPE tankage allows for custom configurations based on client needs. Add and remove various zones as needed for effluent requirements.

SYSTEM PRE-PLUMBED, PRE-WIRED; PLUG AND PLAY READY

All systems arrive to the job site fully tested, with internal plumbing and electrical complete. With on-board PLC, HMI and SCADA, it's ready to plug and play with your existing arrangement.

FULLY SKID-MOUNTED MBR SYSTEM

All tanks and equipment are contained on s/s or coated carbon steel skids and designed for truck transport and delivery as complete systems.

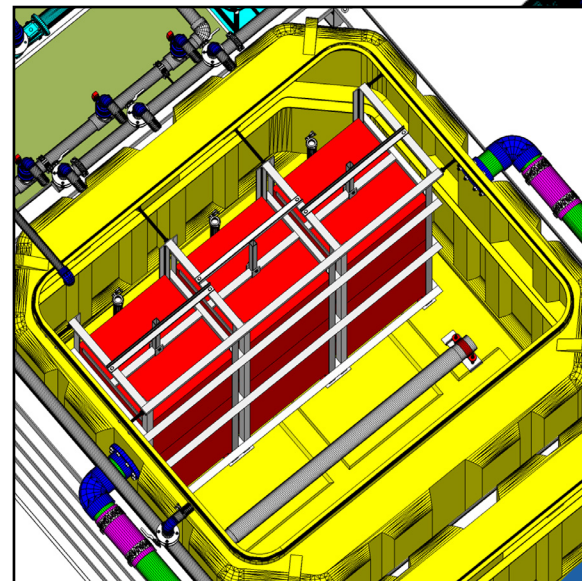

INDUSTRIAL GRADE FLAT PLATE MAXFLOW MEMBRANES

The A3-USA flat plate Maxflow membrane module is designed specifically for wastewater. It's proven itself worldwide; let it work for you.

Modular System Matrix (all waste municipal)

Treatment, GPD	Footprint	Skids
16,000	20'x12'	1
32,000	34'x12'	1
48,000	44'x12'	1
64,000	64'x12'	1
82,000	44'x26'	2
96,000	44'x26'	2
114,000	64'x26'	2
132,000	64'x26'	2
148,000	44'x40'	3
164,000	64'x40'	3
182,000	64'x40'	3
200,000	64'x40'	3

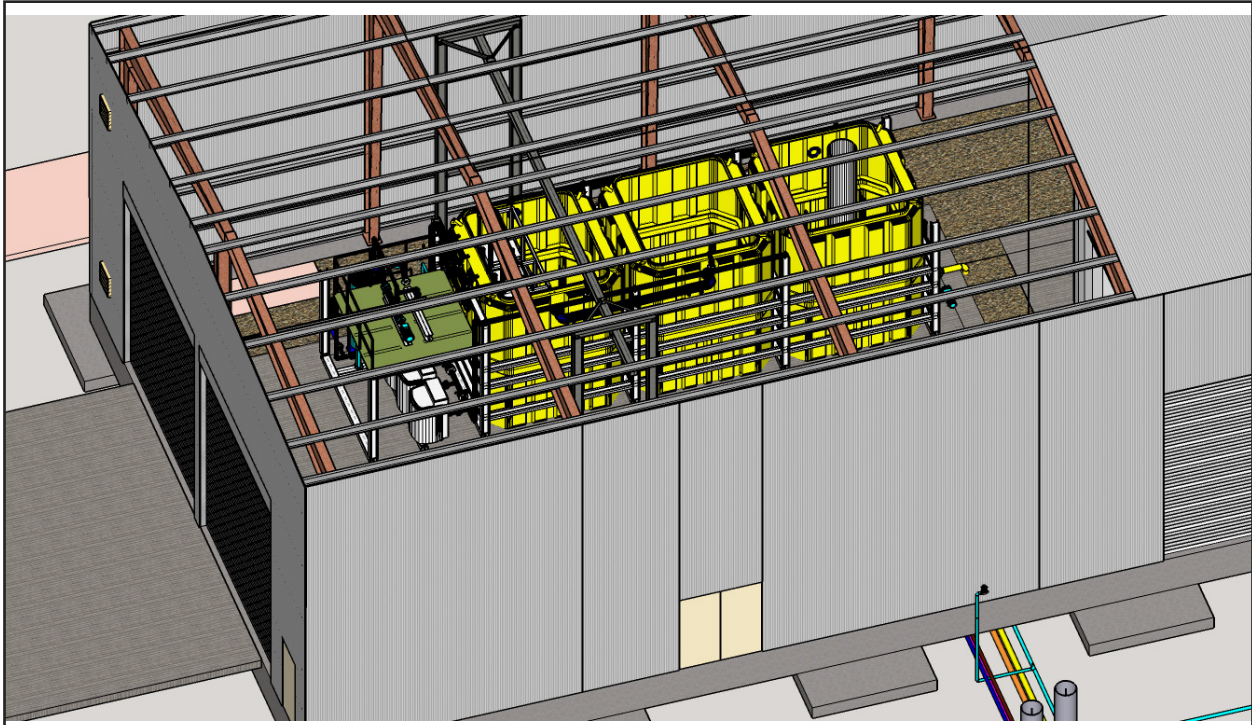

MBR may be placed in a building or set outside on a concrete pad, as needed



Scan for more information

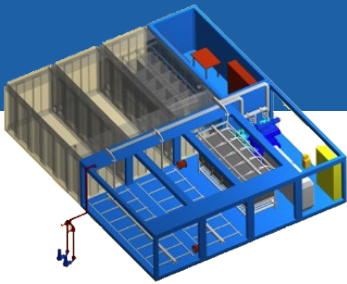

Interested in other design options, smaller or larger?

A3-USA can offer a number of packaged or non-packaged systems, designed for a variety of purposes.

Please contact us for for detailed information.



1674 Fountaintown Rd
Chinquapin, NC 28521

www.a3-usa.com

724.871.7170 | sales@a3-usa.com